

# EVACUATION DIAGRAM LISMORE CENTRA TOURIST PARK

50 Dawson Street, Lismore, NSW, 2480, Australia.  
Phone: (02) 6621 6581

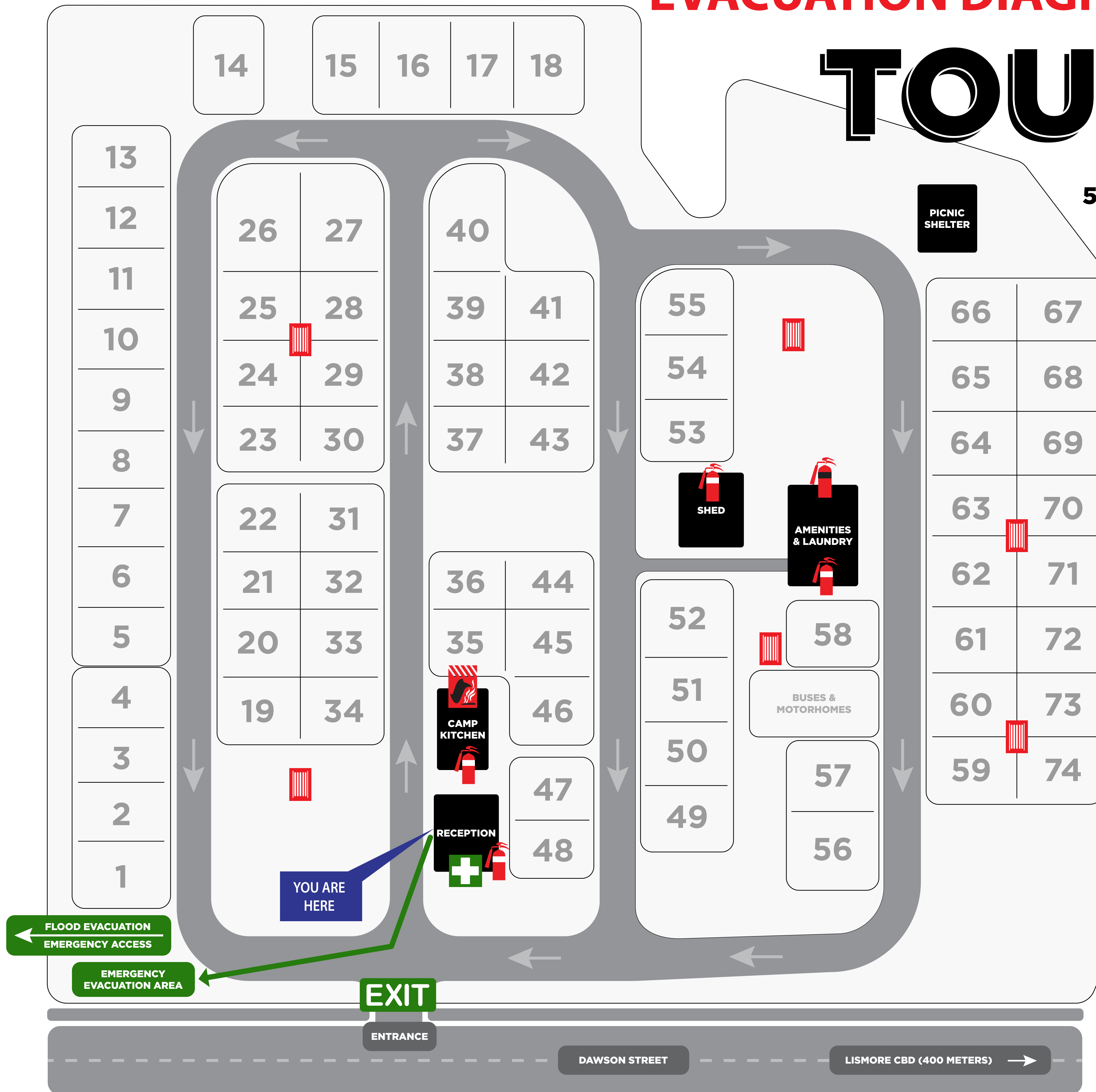
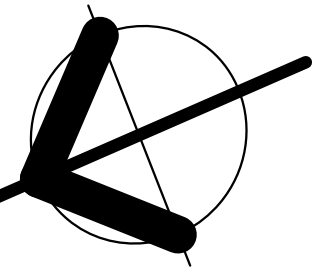

## EMERGENCY CONTACT PHONE NUMBERS

Police, Ambulance or Fire	000
Lismore Base Hospital	(02) 6624 0200
Park Management (after hours)	(02) 6621 6581
State Emergency Services (SES)	132 500
Poisons Information Centre (24hrs)	13 11 26

## EMERGENCY EVACUATION

When officially notified that an EMERGENCY exists you should:

- Secure your valuables
- Close & secure windows and doors
- Turn off power & gas at your site
- Gather everyone registered to your site
- Walk to Evacuation Assembly Area
- Notify Park Staff of your arrival at Evacuation Assembly Area
- Listen and follow park & emergency service personnel instructions

## EMERGENCY PROCEDURES

- R** REMOVE people from the danger area. Safety to self, scene and others
- A** ALERT all occupants, ensure an alarm has been raised. Notify Park Staff 6621 6581  
DIAL 000
- C** CONFINE the Smoke and Fire. Keep doors and windows closed to restrict the spread of the fire. Attempt to EXTINGUISH the fire if trained and if safe to do so.
- E** EVACUATE the park if necessary or if advised to do so.

- FIRE EXTINGUISHER DRY POWDER
- FIRE EXTINGUISHER CARBON DIOXIDE
- FIRST AID
- FIRE HOSE REEL
- FIRE BLANKET
- EVACUATION ROUTE