

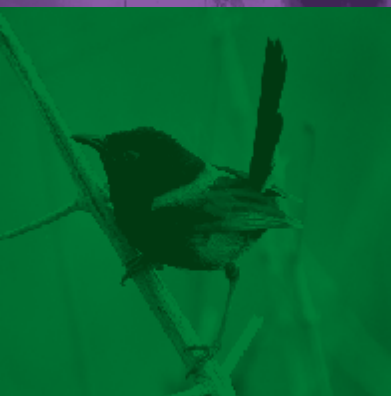

LOCAL MATTERS

LISMORE CITY COUNCIL NEWS
ISSUE 70, 14 SEPTEMBER 2016



WWW.LISMORE.NSW.GOV.AU



CONSTRUCTION OF NEW GALLERY BEGINS

Construction of the \$5.8 million Lismore Quadrangle project at the old Lismore High School site off Keen Street began last week.

The Lismore Quadrangle project includes a new Lismore Regional Gallery in the old C Block building as well as a public piazza bordered by the new gallery, Lismore Library and the Northern Rivers Conservatorium.

Lismore Regional Gallery Director Brett Adlington (*pictured right*) said a gallery for Lismore was first mooted as far back as 1902. In 1954, Council opened the current premises as a 'temporary gallery'.

Brett said it is estimated the new gallery and quadrangle will boost annual visitor numbers to the precinct to 300,000 people, create 27 direct jobs, and expand Lismore's economy by \$1.8 million annually.

The new gallery has been designed by Bangalow-based architect Dominic Finlay-Jones, who also designed the Lismore City Hall refurbishment.

"The new gallery and quadrangle will become a strong anchor for the city centre, attracting thousands of tourists and local residents, who will inevitably flow into our CBD to shop and socialise," Brett said.

"The new quadrangle will be a focal point for the precinct and provide a public gathering place where people can meet, enjoy lunch or read a book, as well as giving the city centre a new outdoor performance venue all year round."

The project has been funded with \$2.8 million from the federal government's Stronger Regions Fund, \$120,000 from the Lismore Quadrangle Pledge Campaign, \$300,000 from the sale of the existing

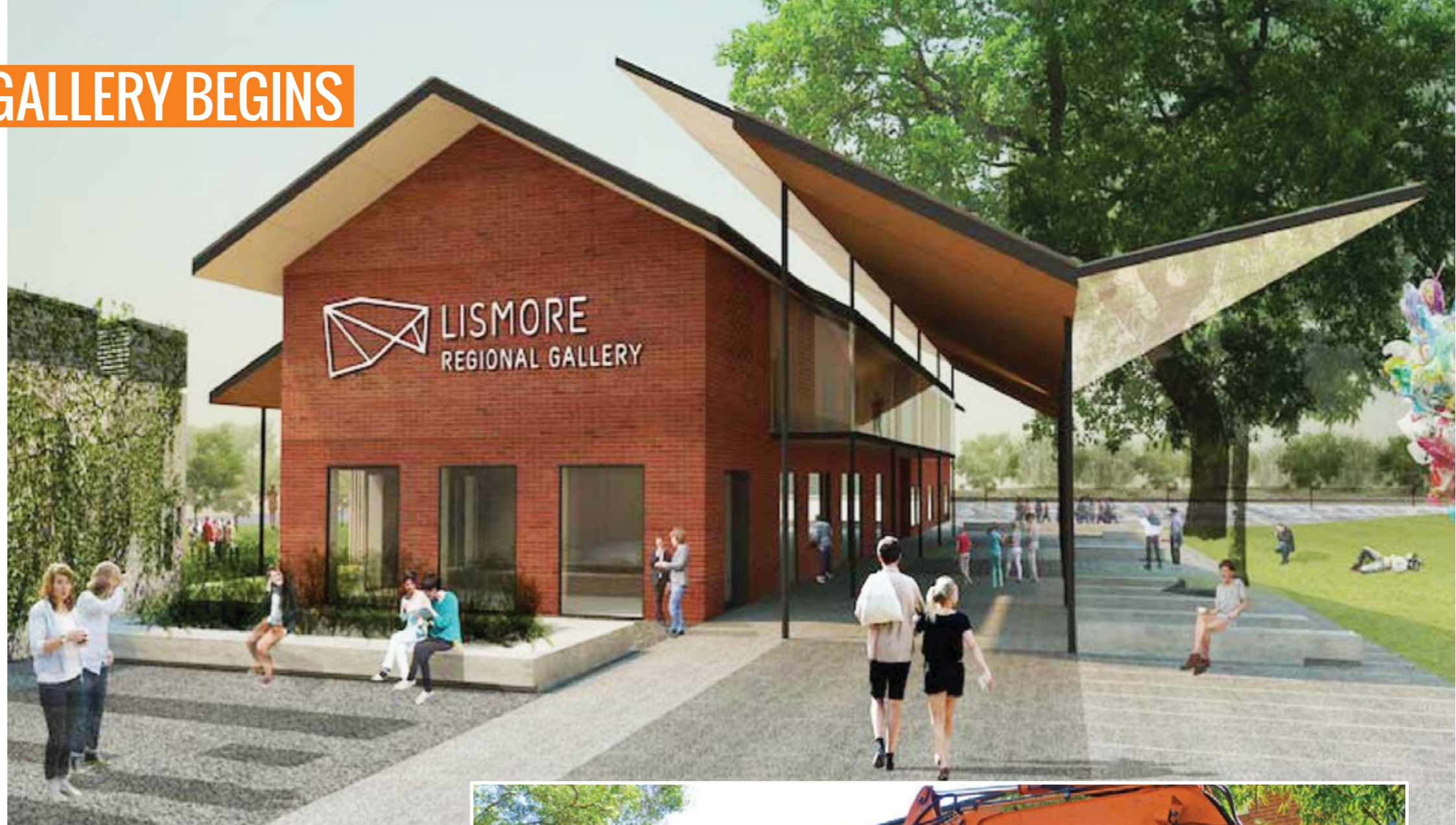

gallery building, \$126,800 in other public donations, a \$110,000 Arts NSW grant, and a \$500,000 donation from the Margaret Olley Arts Trust. Council will fund the remainder with borrowings of up to \$1.9 million, and Friends of the Gallery will work to boost fundraising to help minimise Council costs.

The project is expected to be complete by July 2017.

SUSTAINABLE HOUSE DAY EXPO

SHOWCASES BIG IDEAS IN TINY PACKAGES

Don't forget the 2016 Sustainable House Day Expo coming up this Saturday, 17 September at Mullumbimby Civic Hall.

Event Coordinator Sandi Middleton said last year more than 500 people attended the Sustainable House Day Expo and that figure was expected to grow in 2016.

“Sustainability and tiny homes in particular have really captured people’s imaginations – it’s wonderful to think that living simply and with a small footprint is actually becoming desirable,” Sandi said.

“Sustainable design principles do not have to mean foregoing any comforts... in fact, often these principles help us cool and heat our homes more effectively, and save us money. There is no downside to going sustainable, and people are really catching on to that.”

The popular annual event is free and people can enjoy a range of activities throughout the day including the following:

- Showcase of more than 40 entries in the 2016 Tiny Homes Design Competition. View designs from amateur and professional entrants and be inspired by their clever ideas and ingenuity.
- Tiny Homes Design Competition awards ceremony. Discover who the judges selected to share in \$4000 worth of prizes and take home the top gongs for best design.
- Speed Date a Sustainable Designer. A new segment where you can get up close and personal with expert designers and pick their brains for the best sustainability techniques.
- Green Building and Living Trade Show – check out stalls from 15 local businesses selling eco-friendly products and services. Discover the latest products for your building or retrofitting project.

- Love Food Hate Waste cooking demonstration. Learn how to turn your leftovers into delicious new meals quickly and simply. Take home recipes and ideas, reduce your food waste and save money.
- People’s Choice Award – you be the judge. Pick your favourite tiny house designs and vote for the People’s Choice winner.
- Food vans, refreshments and coffee on site. Lots of yummy sustenance to keep you fed and watered!

The Sustainable House Day Expo runs from 10am to 3pm and everyone is welcome. For more information visit www.sustainablehousedaynr.org.

The 2016 Northern Rivers Sustainable House Day Design Competition is a joint project by Lismore City Council, Byron Shire Council, Ballina Shire Council, Tweed Shire Council, The Green Building Centre, Nimbin Neighbourhood & Information Centre, North Coast TAFE, Self Seed Sustainability and Dorrroughby Environment Educational Centre. The 2016 event is sponsored by Summerland Credit Union and KoHo.



DON'T FORGET SECOND HAND SATURDAY NEXT WEEKEND



Second Hand Saturday is the biggest coordinated garage sale day on the North Coast and is coming up on Saturday, 24 September.

Last year there were more than 900 garage sales held across the Northern Rivers and this year is expected to be even bigger.

The event is coordinated by North East Waste and its constituent councils to try and keep household items out of landfill. Millions of tonnes of waste are sent to landfill by Australian households each year, and much of it is not ready for the scrap heap.

Second Hand Saturday is a great way to recycle pre-loved goods and ensure that items you may no longer want can enjoy a second life with someone else.

For shoppers, it's a bargain hunter's paradise.

In past years, as well as individual garage sales, neighbours have held street sales while others have run 'free' garage sales and 'pay what you think its worth' garage sales. Charities and schools also host their own sales.

"Buying from a garage sale is a great way to do your bit for the environment and save money at the same time. It's a win-win," Linda Tohver from North East Waste said.

"If you're in search of something special there's a good chance you'll find it... We've had all sorts of things registered including flight simulators, collectables, antiques and caravans. Who knows what you might find!"

A list of garage sale addresses will be printed in *The Northern Rivers Echo* on Thursday, 22 September and *The Northern Star* on Saturday, 24 September. Or visit www.secondhandsaturday.com.au.

EVENT REMINDERS THIS WEEKEND

Free field day for cattle farmers

The final Rural Landholder Initiative field day for 2016 is this Saturday, 17 September.

The Boatharbour Beef Grazing and Biodiversity Field Day is for local cattle graziers in the Wilsons River catchment who wish to improve water quality and habitat on their properties.

The day is free with morning tea and lunch included. RSVP is essential to 1300 87 83 87.

Community planning day at Jiggi Hall

A community planning day is being held at Jiggi Hall this Saturday, 17 September, to gather ideas and aspirations for a Community Plan.

People from the following communities are invited to attend: Bentley, Blakebrook, Booerie Creek, Bungabbee, Goolmangar, Fernside, Jiggi, Leycester, North Lismore, Rock Valley, Spring Grove and Tuncester.

We previously held planning days at Rock Valley and Goolmangar halls, and input from Rock Valley has been collated. However, as the Goolmangar Hall session was poorly attended we are holding an additional community planning day, this time at Jiggi Hall.

The day runs from 9.30am to 3.30pm and food is provided. It's not too late to RSVP – phone Jacqui Kirchen on 1300 87 83 87.

Annual Carp Muster

The Casino RSM Social Fishing Club is hosting the annual Carp Muster this Saturday and Sunday, 17-18 September, in the Wilsons, Richmond and Bungawalbin catchments.

You can win great prizes and help rid our local rivers of this introduced pest, which now outnumbers native species, makes our rivers dirty and destroys the roots of riverbank trees.

Weigh-in is on Sunday from 8am to 2pm behind the Casino RSM Club. Registration is \$20 adults, \$15 pensioners and \$10 for school students. Register at www.casinorsmfishingclub.webs.com.



LANDHOLDERS WANTED TO IMPROVE KOALA HABITAT IN LISMORE'S NORTH WEST

Council is calling for expressions of interest from landholders in the north west of the Lismore Local Government Area who would like to improve or create koala habitat on their properties.

This includes landholders in Nimbin, Stoney Chute, Blue Knob, Jiggi, Mountain Top and Terania Creek.

The expression of interest is part of the ongoing Rural Landholder Initiative, which is a key part of Council's Biodiversity Management Strategy. The Rural landholder Initiative is a capacity building program that assists rural landholders to manage, enhance and protect biodiversity on their properties.

We are now seeking expressions of interest from landholders in koala corridors or on properties that have evidence of resident koalas.

Successful landholders will have koala habitat on their property improved through bush regeneration and/or revegetation undertaken by contractors. The contractors will be supported by a Green Army team made up of 10 participants and one qualified team leader. The Green Army is a six-month program for 17-24 year olds to train and work in the environment.

For more information phone 1300 87 83 87 or to complete an expression of interest, visit www.lismore.nsw.gov.au.

This project has been assisted by the New South Wales Government through its Environmental Trust.

SAVE THE DATE... THE ARTY PARTY IS BACK!

The Arty Party is coming back to Lismore on Thursday, 6 October when Spinks Park will be transformed into a family friendly children's art festival for a day of playful art-making.

Hosted by Peggy Popart, the festival features Roundabout Theatre performers, local artists, storytellers, musicians, and dancers who will engage the community in fun, creative activities.

Make sure you save the date: Thursday, 6 October from 11am to 4pm in Spinks Park. Take the kids and discover the joy of art – for free!

The Arty Party is presented by 100 Wonder Place in partnership with the Lismore Regional Gallery, the Lismore Business Panel and Lismore City Council.

The event will be Auslan interpreted and is wheelchair accessible. For more information, visit 100wonderplace.com.au. You can also check out the Facebook page www.facebook.com/100WonderPlace/ or donate to their Pozible campaign at pozible.com/project/the-arty-party.



The Arty Party, copyright Rebecca Rushbrook Photography, 2015.



DEVELOPMENT CONSENTS ISSUED

ENVIRONMENTAL PLANNING AND ASSESSMENT ACT

In accordance with the provisions of Section 101 of the Act and Clause 124 of the EP&A Regulation, notification is given that the undermentioned developments have recently been granted consent.

15/8-2 205 Dawson Street, Girards Hill: Section 96(1A) modification to amend approval from a secondary dwelling to an expanded dwelling.

15/260-2 20 Gordon Blair Drive, Goonellabah: Section 96(1A) modification to change the configuration of the plans to accommodate Telstra requirements and amend front fence design including retaining walls and alteration to subdivision plan.

15/286-2 54 Main Street, Clunes: Section 96(1A) modification to reduce the area of the approved floor plan by 80% being a store room and bathroom only.

15/307-2 3/45 Cullen Street, Nimbin: Section 96(1) modification to amend hours of operation to 7am to 10.30pm Monday to Sunday (condition 2).

16/10 14 Weismantel Road, Nimbin: Detached dual occupancy with associated alterations and additions.

16/20 8 Eric Place, Lismore Heights: Change of use of an existing garage to a secondary dwelling with a building line variation to 1.98m to Noel Street.

16/38 20 Wilson Street South, South Lismore: Construction of an industrial building for the purpose of fabrication and installation of residential and commercial joinery, and second tenancy.

16/81-2 1 Atfield Street, South Gundurimba: Section 96(2) modification to use the existing 4.8m pipe with new sidewalls to upgrade the driveway and amend Condition No. 14.

16/149 9 Foleys Road, South Lismore: Change of use to light industry including repair, recycling and sale of whitegoods.

16/153 54 Bridge Street, Wyrallah: Residential village subdivision of one lot to create two lots.

16/162 3 Centenary Drive, Goonellabah: Change of use to general industry (wholesale bakery) and associated fitout.

16/165 6 Taylor Street, South Lismore: Caretaker's residence.

16/167 7 Tuntable Creek Road, The Channon: Use of existing building for farm stay accommodation.

16/193 70, 86, 90, 116 and 118 Brunswick Street, Lismore: Building for depot and general industry.

16/202 131 Ridgwood Road, Rosebank: Detached dual occupancy with associated alterations and additions.

16/204 247, 247A, 257, 281 and 295 Fredericks Road, Caniaba: Subdivision (boundary alteration).

16/217 9 Millar Street, Goonellabah: Dwelling.

16/220 18 Parkwalk Drive, Goonellabah: Strata subdivision (2 lots).

16/221 18 Lomandra Avenue, Caniaba: Dwelling.

16/224 44 Hillcrest Avenue, Goonellabah: Dwelling and retaining walls.

16/225 1112 Jiggi Road, Jiggi: Demolish existing awning and erect a garage and replacement awning to existing dwelling in two stages.

16/226 54 Main Street, Clunes: Cabana, fencing and retaining walls to existing pool.

16/227 33 Phyllis Street, South Lismore: Demolish existing covered deck and replace with larger covered deck.

16/238 6 Ridgeland Close, Richmond Hill: Alterations and additions to existing dwelling, demolish shade house and construct a shed with building line variation to 8.49m to Ridgeland Close.

16/240 750 Tregeagle Road, Tregeagle: Demolition of a shed and construction of a machinery shed.

16/248 31 Lomandra Avenue, Caniaba: Dwelling.

16/225 1 Dunoon Road, North Lismore: Aboveground swimming pool.

Details of applications and consents, together with conditions attached, may be inspected at Council's Corporate Centre during business hours or via DA Tracking at www.lismore.nsw.gov.au.



WANT TO MAKE YOUR BUSINESS MORE ACCESSIBLE?

Earlier this year, Council resolved to waive the application fees for development applications that have the primary purpose of improving accessibility in existing buildings.

If you are a local business or organisation and you would like to do some work to improve accessibility, such as ensuring an accessible entrance or making a toilet wheelchair accessible, we won't charge you any fees.

This is part of a push by Council to improve accessibility across the community. Council is not immune and has some access issues at its sites, so we will now audit and prioritise access to Council-owned properties.

Many business owners may not realise that they are losing significant business if their premises is not accessible. People with a disability may not be able to shop as well as other patrons such as mums and dads with strollers or those with mobility issues.

Council has developed a simple, A4 *Missed Business Guide* that provides simple actions all businesses can take to become more accessible. This guide was an initiative of the Lismore Access and Inclusion Committee.

Search for the *Missed Business Guide* at www.lismore.nsw.gov.au or phone Catherine Rosenbaum on 1300 87 83 87.



TRAFFIC ALERTS AROUND THE TRAPS

Lismore CBD: Dawson Street end of John Crowther Carpark

We are installing new stormwater and sewer pipes in the Dawson Street end of the John Crowther Carpark adjoining the Dawson and Woodlark Street roundabout.

During works, we will be temporarily closing a small part of the carpark and its Dawson Street driveway. Alternative access to the carpark will be detoured to Woodlark, Zadoc and Keen Streets/Richmond Lane.

Works are expected to take six weeks.

Base Hospital: Laurel Avenue east of Diadem Street, Lismore

We are replacing a 75m section of the sewer main along the southern side of Laurel Avenue, east of its Diadem Street intersection. We will be temporarily closing a small section of the two-hour time restricted parking lane here for about a fortnight.

There will be minimal disruption for travel in these streets but please drive carefully through this intersection and follow traffic control measures.

Nimbin: Tuntable Creek Road and adjoining Gungas Road

Road drainage works are continuing along the 0.5km section of these roads either side of the Tuntable Falls Road intersection. We are making progress on extending the road culverts here over the next few weeks in preparation for fixing these sections of road over the coming months.

Please follow traffic control measures.

Tucki Tucki: Wyrallah Road

We are continuing to lay new road pavement along Wyrallah Road around its Tucki Tucki Road intersection near the Tucki Cemetery.

We appreciate your patience during these staged roadworks as we continue to fix up significant sections of this busy arterial road.



CALLING ALL RURAL ADVISORS AND CONSULTANTS

Rural advisors and consultants are invited to a free workshop at the Lismore Recycling & Recovery Centre that will look at the environmental and financial benefits of using compost in production.

The workshop will look at the advantages of recycled organics that have been diverted from landfill.

Topics include the following:

- Soil health, environmental and nutrient benefits of compost
- Key characteristics of compost, risks and legislation
- Sources and products
- Possible business arrangements
- Nutrient management planning
- Quality control

Participants will also visit Lismore City Council's compost processing facility to see the compost production in action.

The workshop is on Wednesday, 5 October from 8.30am to 2.30pm.

Attendance is free and refreshments are provided, but registration is essential. Phone Jeff Kraak on 0407 663 535.



PLEASE PUT YOUR BIN OUT THE NIGHT BEFORE COLLECTION

A quick reminder to please put your wheelie bins out the night BEFORE collection.

We have noticed that many people seem to be setting their watches by when the last bin collection took place. If bins aren't picked up the following fortnight because the driver came at a different time (i.e. earlier), then we receive complaints.

Please be aware that due to changes in schedules, for a whole variety of reasons, we may not pick up bins at the same time each fortnight. This is why we always ask people to put their bins out the night before. This ensures that whatever time our drivers arrive, the bin will be collected.

**Please help out our truck drivers and do the right thing!
Thanks everyone.**



YOUR COVER

Bangalow-based architect Dominic Finlay-Jones and Lismore Regional Gallery Director Brett Adlington were at the sod turning for the new \$5.8 million Lismore Regional Gallery and Quadrangle project last Wednesday. Dominic also designed the Lismore City Hall refurbishment. The new gallery and quadrangle is expected to be complete by July 2017. More information inside.



ELECTION RESULTS

At the time of going to press the election had not been held. Final results for the 2016 local government election will be announced no later than Friday, 16 September.

You can view election results at www.votensw.info



CONTACT US:
1300 87 83 87

Lismore City Council's Corporate Centre
is located at 43 Oliver Avenue, Goonellabah.

We are open Monday to Friday from 8.30am to 4.30pm.

Our postal address is PO Box 23A, Lismore NSW 2480.

You can email us at council@lismore.nsw.gov.au



Find us on Facebook and
YouTube or follow us on Twitter.



Local Matters is printed fortnightly on
Australian-made, 100% recycled and
carbon-neutral paper.