

LEGEND**SKATE WORKS**

- 1 1200H Mini Ramp
- 2 1650H Extension
- 3 2850H Deep End
- 4 1500H Quarter Pipe
- 5 2100H Extension Hip
- 6 2250h Flatbank Extension
- 7 900H Mogul

- 9 2250H Quarter pipe extension
- 10 6000H Rainbow Vert wall
- 11 Euro gap to vert wall

- 13 Stacked ledges and manny pad
- 14 Ledge to china bank
- 15 400H inside / outside ledge
- 16 Rainbow pole jam
- 17 750H quarter pipe returns
- 18 Long hubba and down rail
- 19 Transfer ledge
- 20 800H big out ledge
- 21 Big hubbas
- 22 Kink rail with euro gap
- 23 Bank to kerb
- 24 Street spine transfer
- 25 900H Rock gap hip
- 26 1100H quarter pipe retrun

- 28 Quaterpipe rock gap transfer
- 29 1200H Flat bank
- 30 1100H Big kicker to flat
- 31 A-frame rails
- 32 Bank to ledge
- 33 500H Out rail / rail gap
- 34 Kicker to kicker rock gap
- 35 2100H big Quarter extension
- 36 1500H Quarter pipe return

**CONCEPT DESIGN - SKATE**

CLIENT

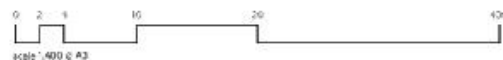
**CONVIC**

Unit 13, 46-50 Regent Street
 Richmond VIC 3121
 T (03) 9486 9899
 convic.com

PROJECT
 LISMORE URBAN SPORTS PRECINCT

TITLE
 FINAL CONCEPT DESIGN - SKATE

DATE
 13.05.24

REVISION
 A







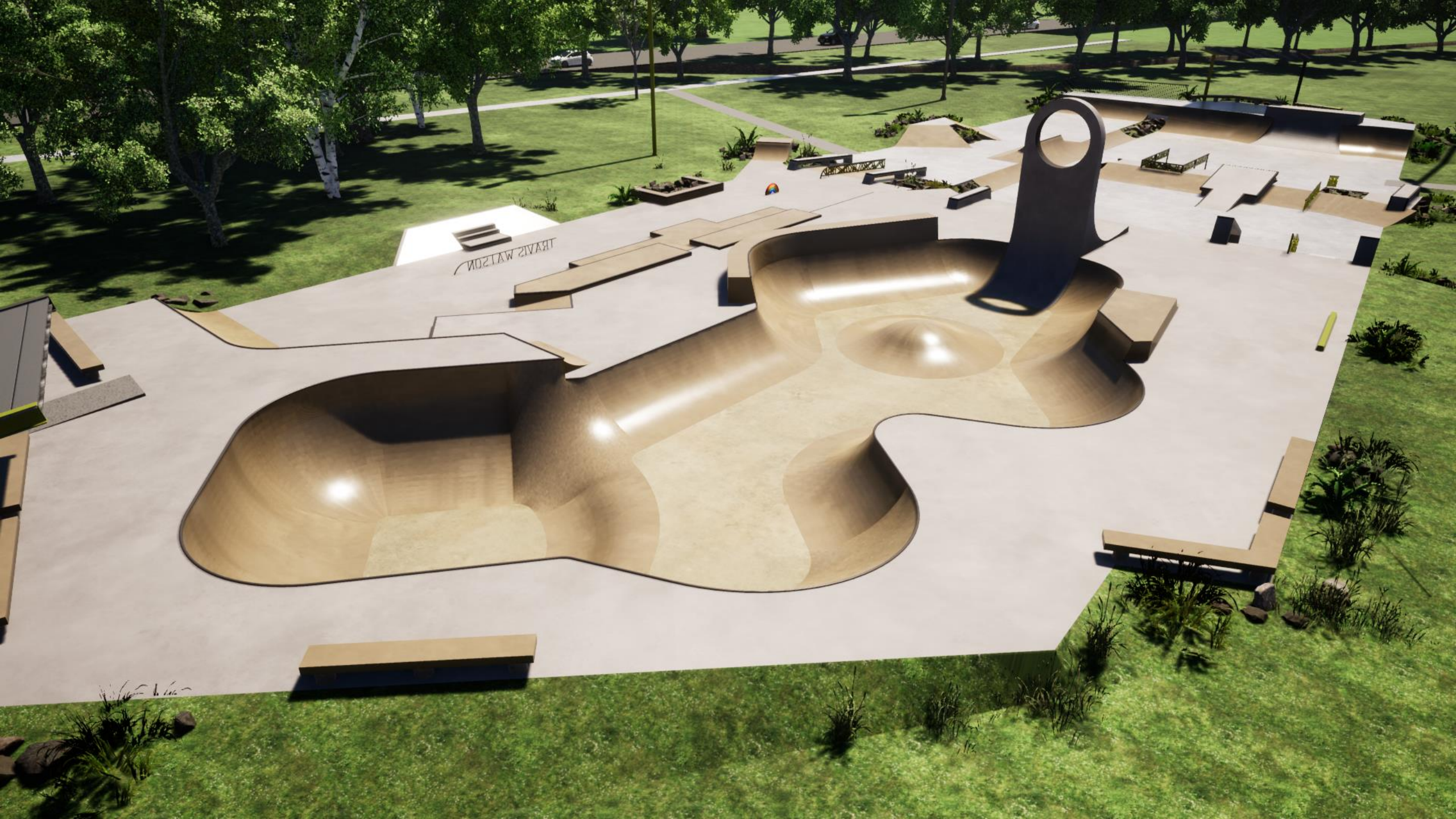

TRAVIS WATSON









TRAVIS WATSON



TRAVIS WATSON



TRAVIS WATSON