



# EXISTING SITE CONDITIONS

## BLISTER ON CULLEN STREET

The blister contains

- Ageing and unsafe furnishings.
- Cracked concrete with a distressed finish that extends under rock walling.
- Rock walling showing signs of missing rocks and mosaic insets requiring stabilisation.
- Trees and palms with inadequate room for root development.
- Exotic landscape plantings that are problematic for the sustainability of the existing stone walling.
- Bins which take up space better suited to seating and landscaping.
- Amenity planting of exotic groundcovers.
- Steel tree guards
- Lack of adequate lighting
- Lack of shading



Blister on Cullen Street Existing Character Image



Blister on Cullen Street Existing Character Image



Blister on Cullen Street Existing Character Image

## PEDESTRIAN LINK BETWEEN CULLEN STREET AND PUBLIC PARKING

The walkway contains

- A narrow asphalt pathway non compliant for disability access.
- Exotic plantings at the base of adjacent buildings.
- An embossed mural.
- Air conditioning units on building wall.
- A side entry to the Environment Centre.
- A Mandarin tree and Golden Cane Palm that are problematic for existing and future built form and path.
- An asphalt parking and vehicle access area leading to public parking areas.



Pedestrian Link Existing Character Image



Pedestrian Link Existing Character Image



Pedestrian Link Existing Character Image



Pedestrian Link Existing Character Image



Pedestrian Link Existing Character Image



Pedestrian Link Existing Character Image

## PROPOSED LOCATION FOR A GREEN PARKLET WITHIN CULLEN STREET ROAD RESERVE

The proposed Parklet area contains

- Road signage.
- A power pole.
- A sloping grass verge.
- Concrete steps from the kerb to the existing pedestrian pathway.



Green Parklet Existing Character Image



Green Parklet Existing Character Image



Green Parklet Existing Character Image

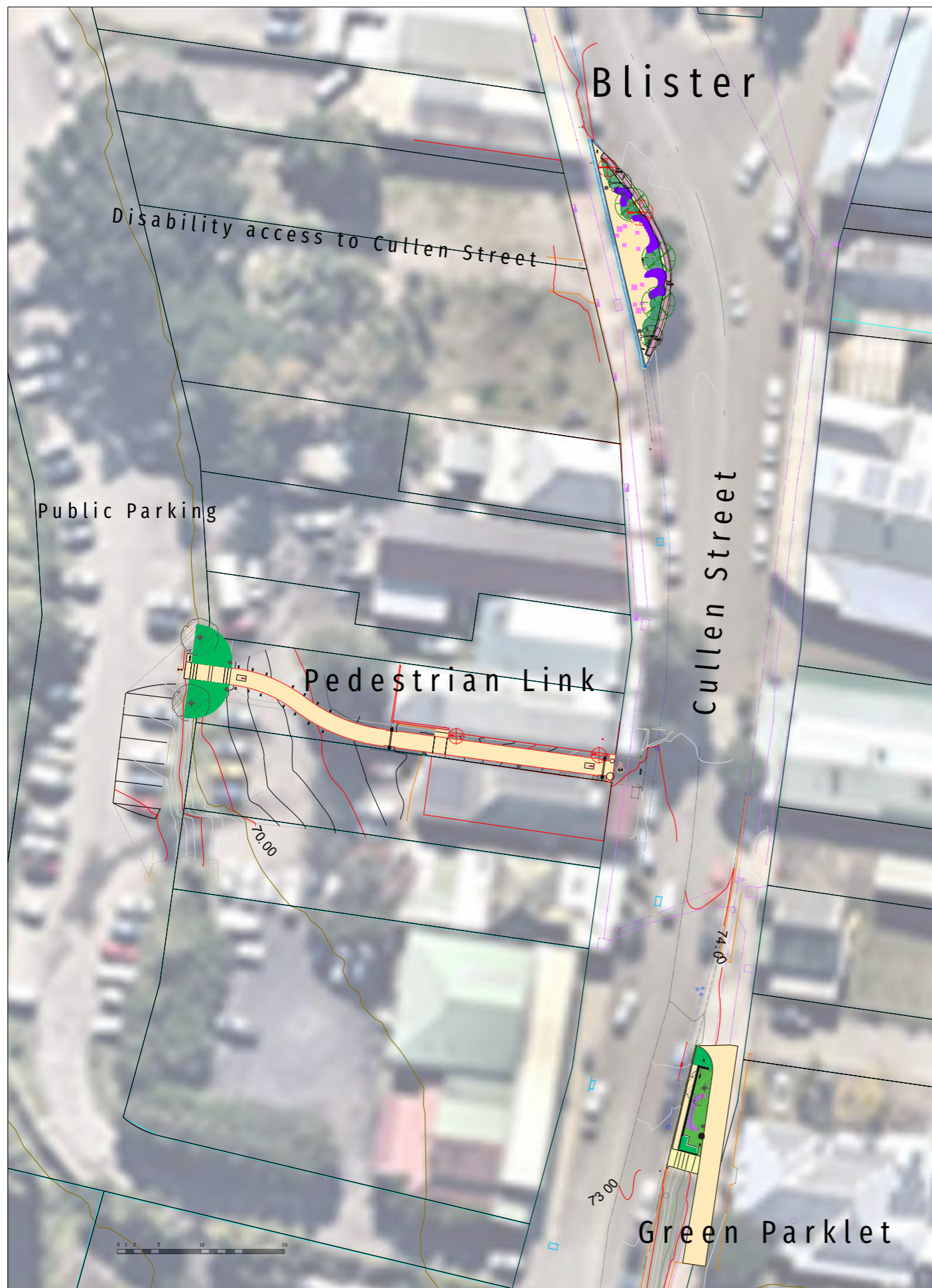

## BLISTER

- The blister will be made safe, inviting and showcase local artists in the paving detail and sculptural seating.
- New plantings of native species and limited exotics will reference local vegetation communities and soften pavements and the existing rock walling.
- Proposed concrete formed seating to be designed and installed by local artists and the community.
- New seating will replace ageing benches and tables providing opportunities for groups and individuals to gather.
- Garden beds will be extended to promote the sustainability of existing trees and palms to be retained.
- Signage will provide wayfinding and educational information.
- Signage incorporating braille will be included where the path from public parking areas meets the pedestrian pavement.
- Fairy lights are proposed to be hung in the existing trees.

## PEDESTRIAN LINK

- The walkway will be the entry to Nimbin for visitors parking in the public car park.
- Stairs from the car park will feature colour and textured art works that speak to Nimbins recent and pre-settlement histories.
- The planting of two large rainforest trees (*Flindersia Schottiana*) will mature into legacy trees that mark the entry.
- Gardens either side of the stairs will provide for an attractive back drop to the entry and soften the concrete and asphalt areas.
- Signage at the entry and termination of the walkway will include maps of the village and general information.
- Way-finding is to be placed in the pavement and reinforced through the walk, providing visual and design links to the Nimbin Rainbow Road Walking track.
- Bollards will provide a safe area as the path winds between two parking areas.
- Steel arches are proposed at two locations along the walkway. These arches are to be constructed of steel tube, and be detailed with perforated patterns. Lit from within they will be illuminated poles.
- Solar bollards and festoon lighting in combination with the lit arches will allow for a safe and enchanting entry to the village at night.

## GREEN PARKLET

- The parklet will be created by leveling the road verge and providing a set-down area and access to the existing steps.
- Wayfinding signage will encourage exploration of the villages murals and significant buildings.
- Audio signage provided by the Nimbin Chamber of Commerce proposed along with the installation of a mobile phone stand and bracket to encourage social media (instamoments) of visitors against a backdrop of Cullen Street and the escarpment.

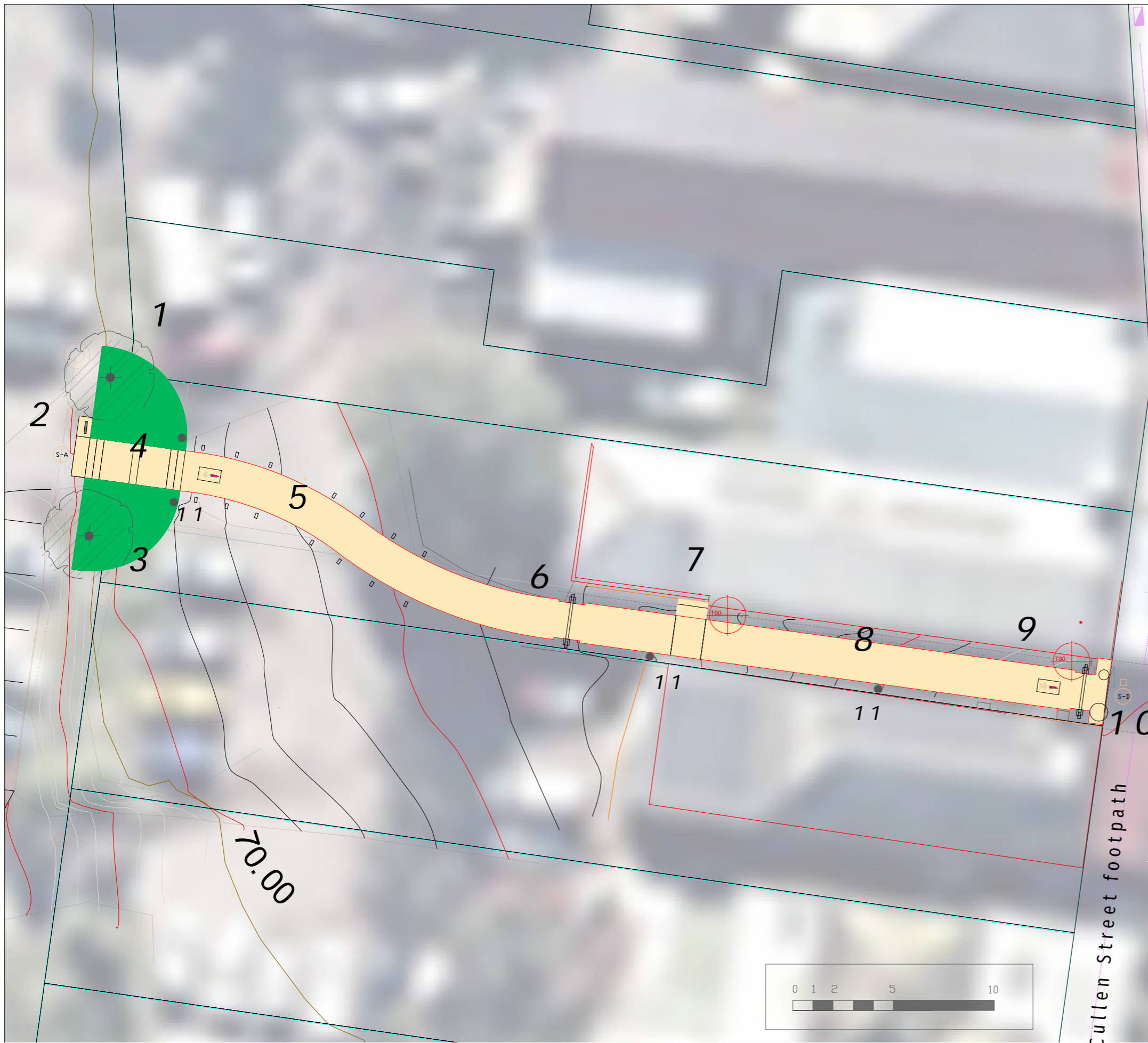

## PEDESTRIAN LINK

- 1-Entry Feature legacy trees at start of walkway.
- 2-Threshold pillar signage.
- 3-Entry Feature gardens.
- 4-Entry Feature steps and landings with art works and 'in pavement' signage.
- 5-Bollards delineating a safe walkway. Bollards include timber perimeter bollards, solar bollards, and lockable and removable bollards to enable planned access by vehicles.
- 6- Steel archway incorporating lighting and climbers.
- 7-Side entry to Environment Centre access upgrade. Removal of Mandarin Tree.
- 8-Festoon lighting strung between buildings and murals on building walls.
- 9-Signage in pavement, second steel archway and removal of Golden Cane Palm and rock edging.
- 10- Threshold Pillar signage.
- 11.Solar Bollard

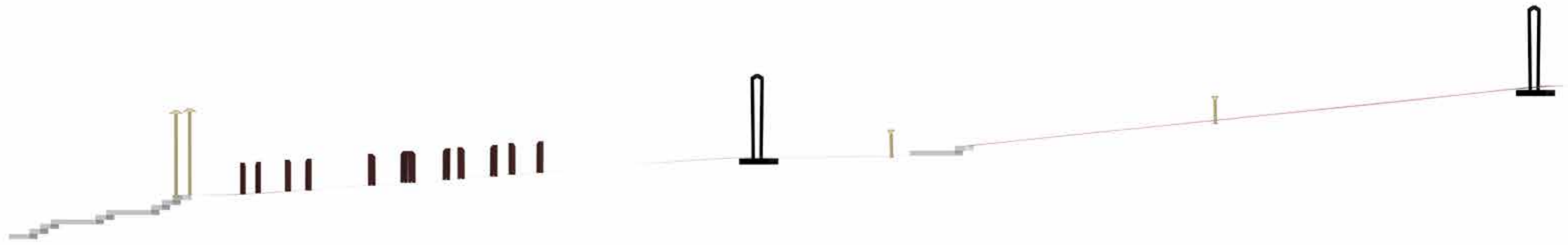

Pedestrian Link- concept-Elevation South

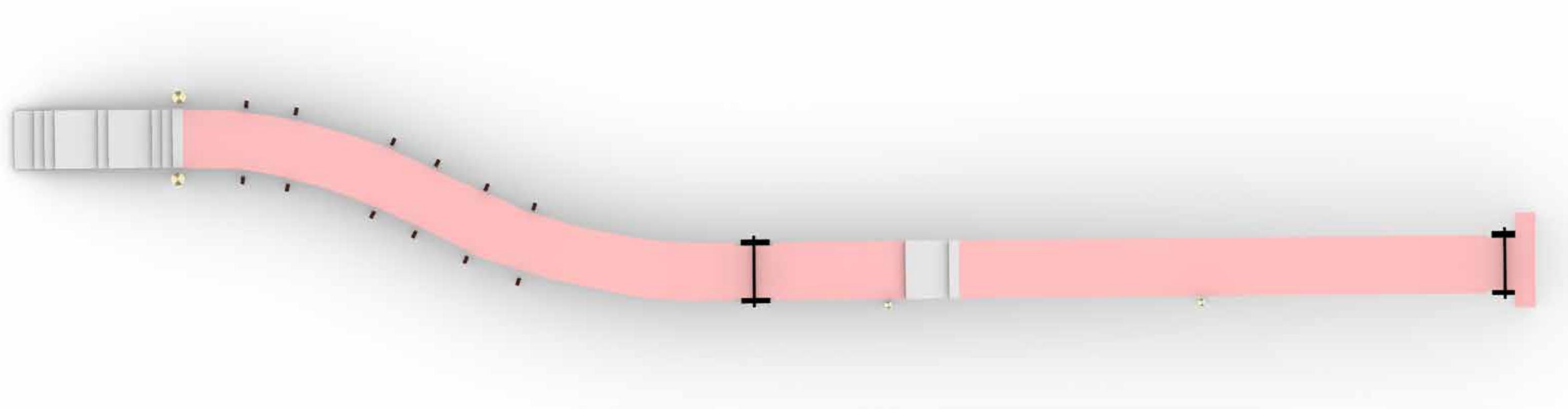

Pedestrian Link- Plan View



Pedestrian Link- concept-Elevation West



Pedestrian Link- concept-Elevation East

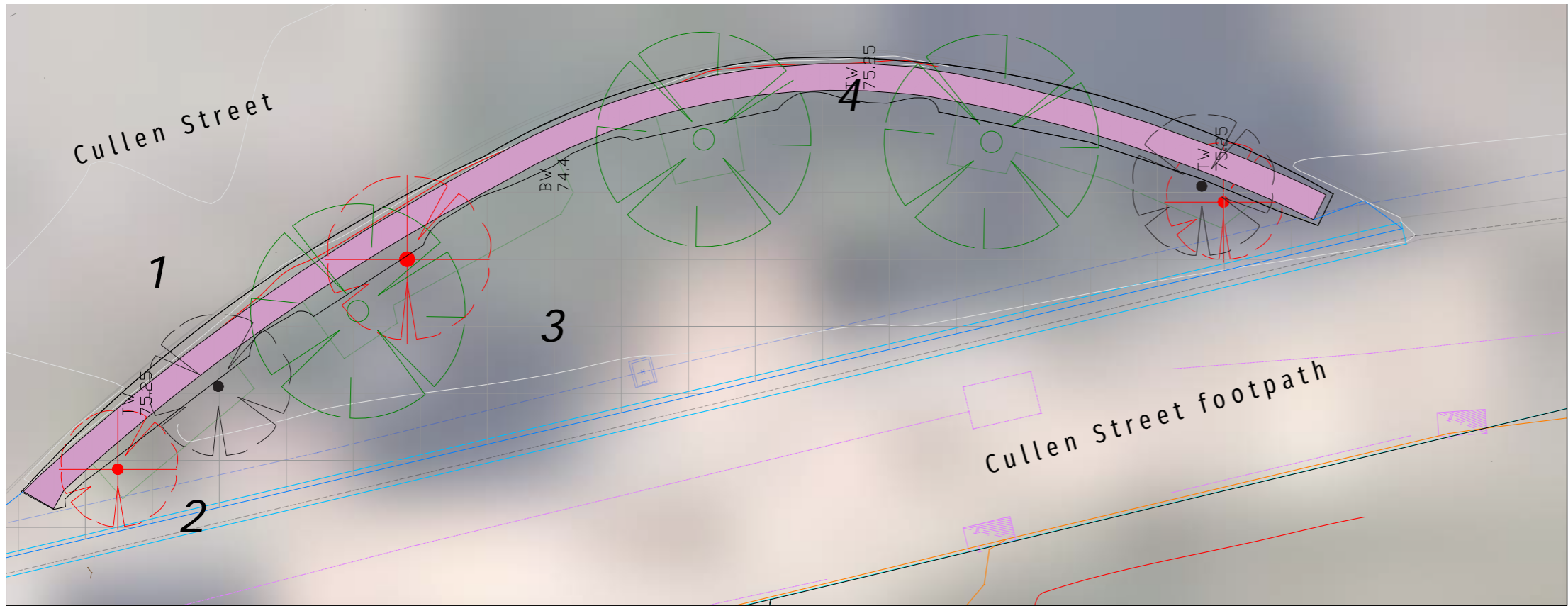

Blister- Demolition

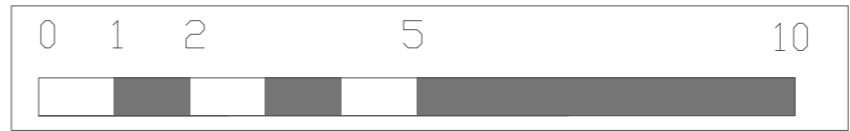

BLISTER

- 1-Bangalow Palms to be retained.
- 2-Exotic palms and plants to be removed.
- 3-Existing pavement and furnishings to be removed
- 4-Relocate existing bins to provide space for seating and gardens
- 5-New plantings of native and bush tucker species
- 6-Rock walling to be retained, repaired and enhanced
- 7- Location and dimension of proposed formed concrete seating by local artists
- 8-New pavement

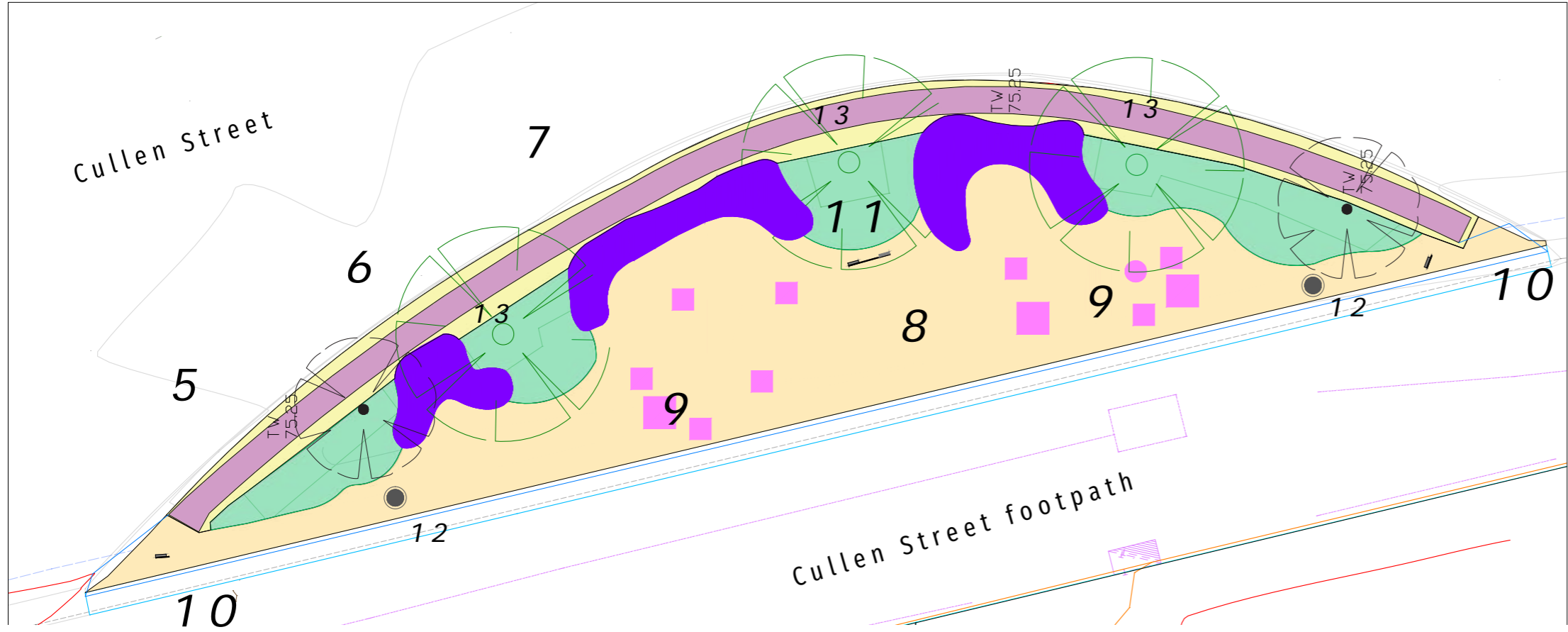

Blister- Setout

- 9-new seating
- 10-Signage on posts
- 11-Signage on frame
- 12-Solar Bollard
- 13-Fairy lights strung through trees

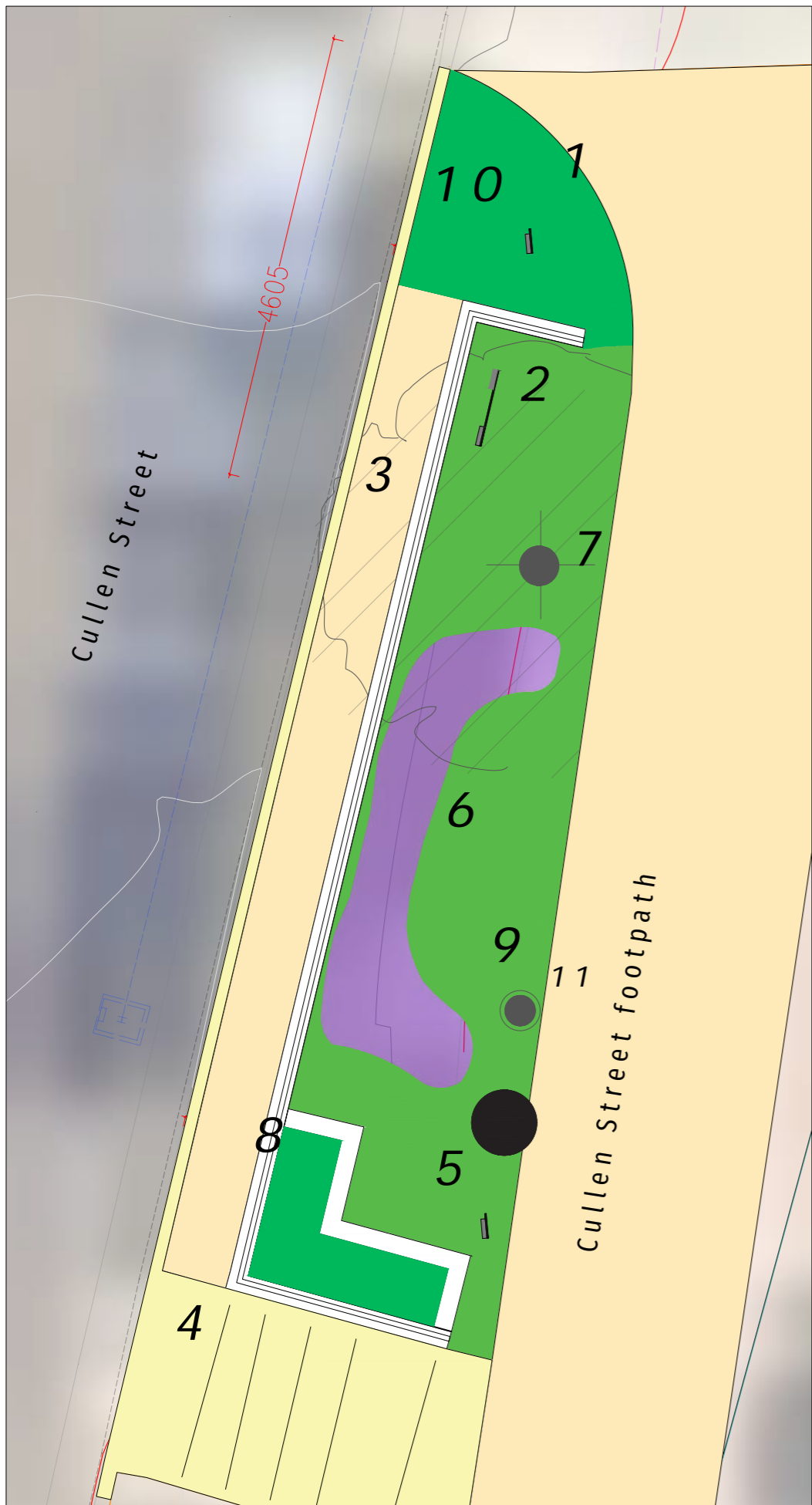

## BLISTER

- 1-Signage on posts
- 2-Signage on frame
- 3-Concrete set down area
- 4-Concrete stairs
- 5-Power pole
- 6-Location and dimension of proposed formed concrete seating by local artists
- 7- Proposed Blueberry Ash shade tree
- 8-Block retaining wall supporting a timber fence and raised planters
- 9-Lawn
- 10-Gardens
- 11-Solar Bollards



# WAY FINDING

## Threshold Pillar Signs

- Location  
 -At the pedestrian link entry steps at the public car-park and at the intersect with Cullen Street. These signs will contain maps, artistic design, Village and Council logos.  
 -Dimensions proposed  
 2400mm high x 620mm wide by 105mm deep

## Directional signage on posts

- Location  
 -At arrival, north and south of the Blister and Green Parklet. These signs will contain clear directional signage to significant locations along Cullen Street.  
 Dimensions  
 Posts 1600 mm high x 200mm wide x 45mm deep  
 Sign- Shape can be customised within a 800mm x 300 mm polygon.

## Directional signage on frames

- Location  
 -At the Blister and Parklet. These signs contain more detailed mapping, educational and cultural information.  
 Dimensions  
 800mm high x 900 wide x 400

## Directional signage on Bollards

- Location  
 -At a minimum at the Disability path connection to Cullen Street where braille can be included (Braille should be included on all signage where sites signed can be reached by persons with a disability)  
 -Dimensions  
 1600mm high x 400mm wide and deep

## Directional signage on pavements

- Location  
 -Repeating signature signage stenciled or recessed in pavements reinforce the precinct colour and symbol themes.  
 -Pavement signage provides visual cues and links to The Nimbin Rainbow Road Walking Track.  
 -Dimensions-varies.



Threshold Pillar Sign

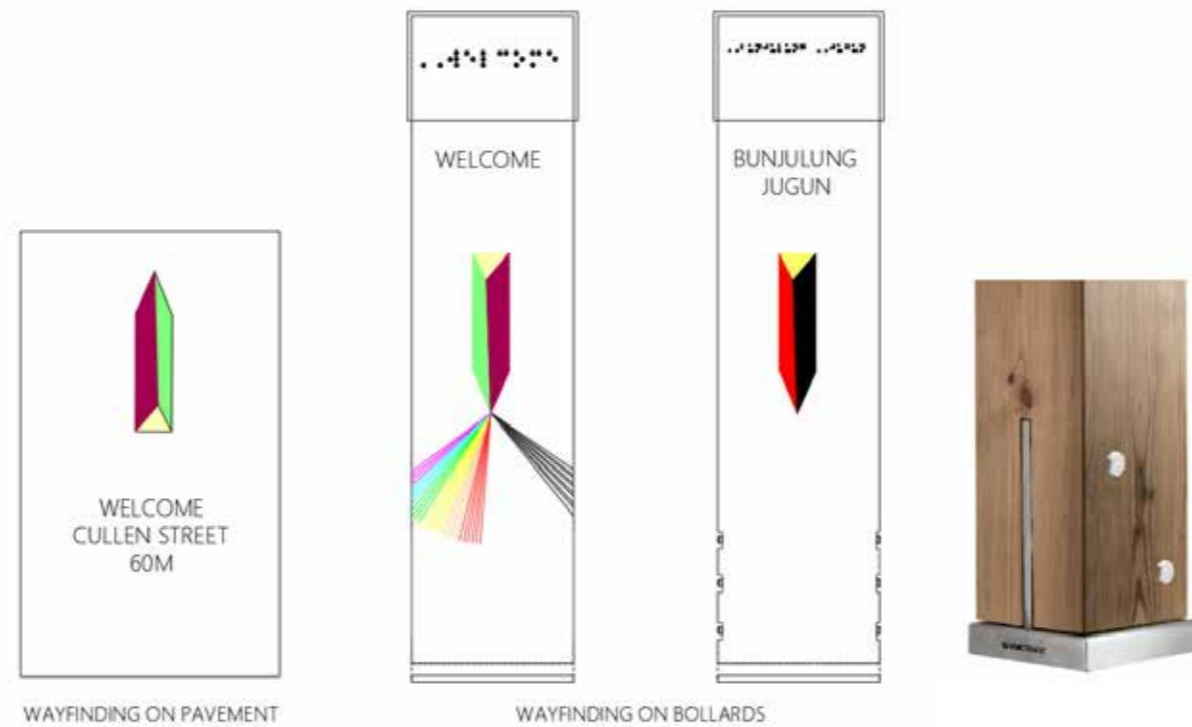

WAYFINDING ON PAVEMENT

WAYFINDING ON BOLLARDS

VT



Coloured concrete

Concept for pavement treatments to be utilised by local artists

Character images; etched concrete. This process can be utilised for wayfinding and artworks and include coloured concrete and varying aggregate colours and textures

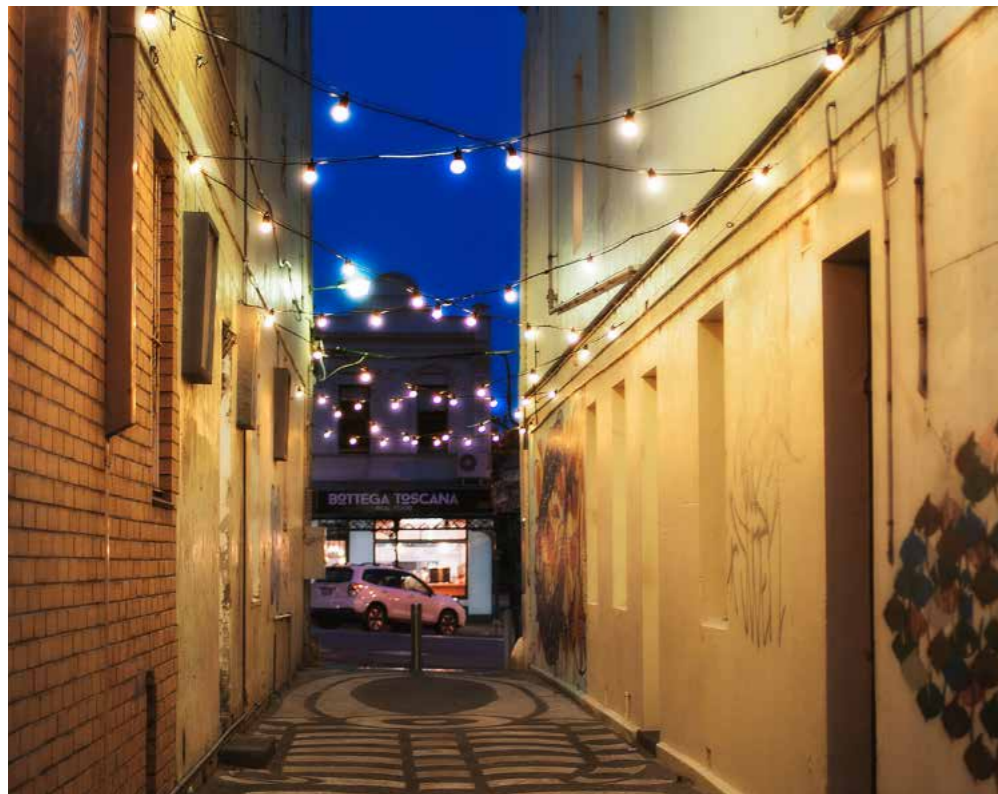

Character image for Festoon Lighting along the walkway

Character image for proposed seating at the Blister

Character image for proposed fencing at Green Parklet

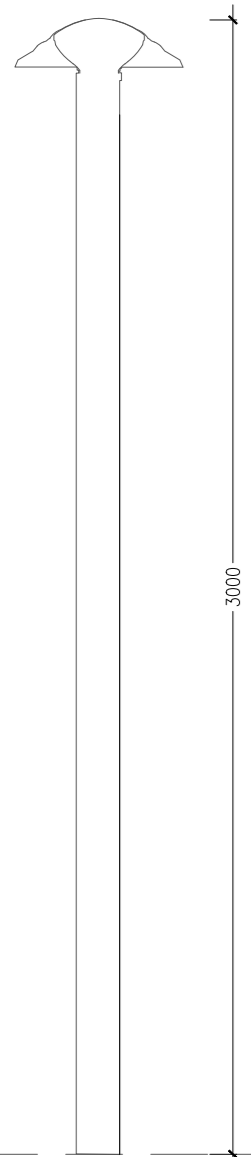

1  
0 CHARACTER IMAGE -SOLAR BOLLARD  
SCALE NTS



1  
0 CHARACTER IMAGE SECURITY BOLLARD  
SCALE NTS

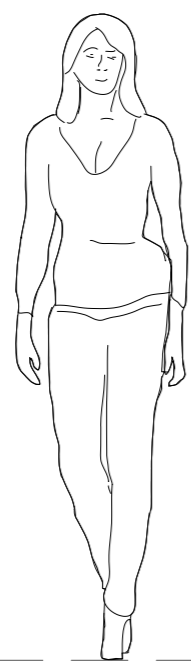
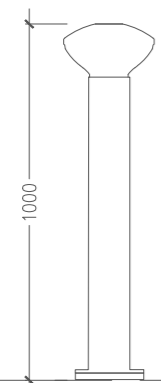

1  
0 TYPICAL DETAIL: SOLAR BOLLARD BOLTED  
TO FOUNDATION OR INGROUND  
SCALE NTS

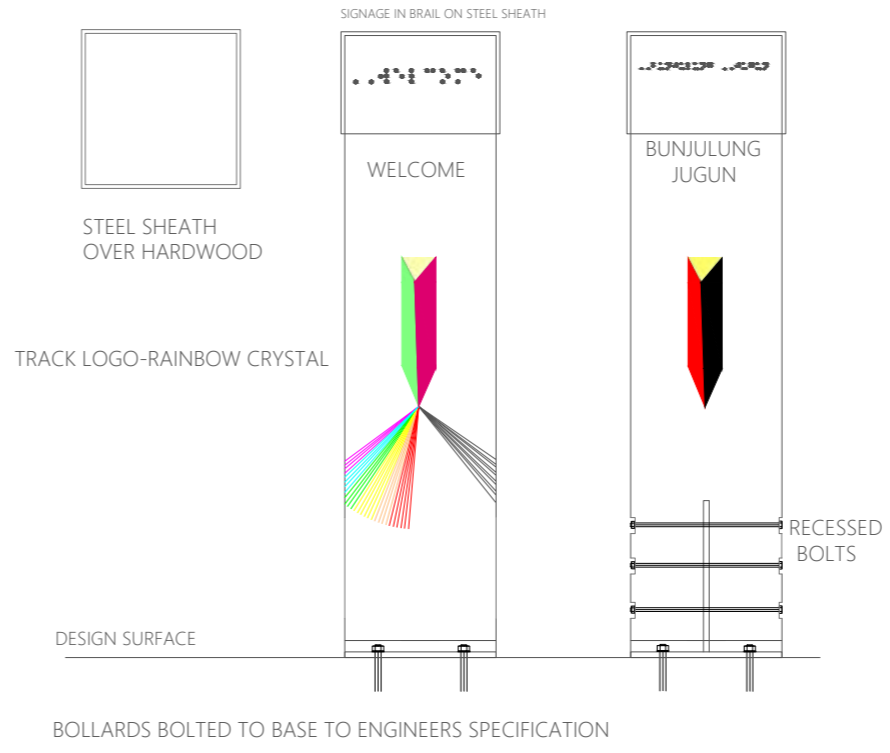

1  
0 TYPICAL DETAIL: FEATURE BOLLARDS DISABILITY COMPLIANT ACCESS AT BLISTER  
SCALE 1:10 @A1



INDICATIVE SHIELD AT BASE TO HIDE BOLTS

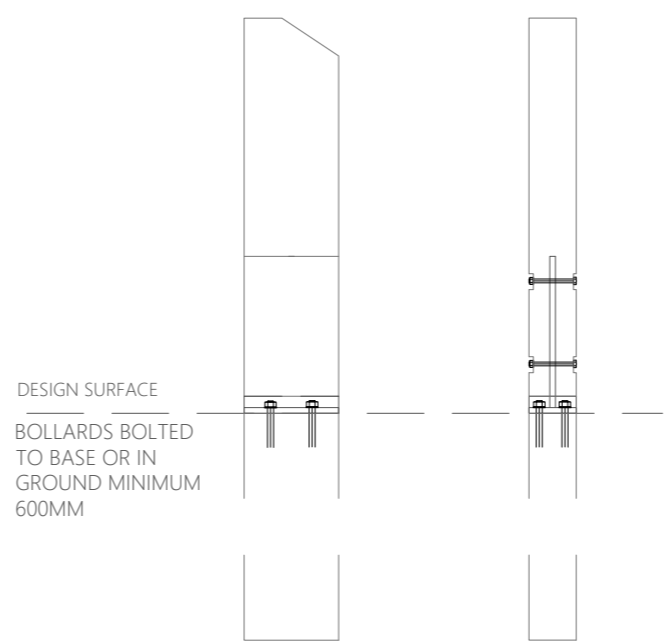

1  
0 TYPICAL DETAIL: TIMBER BOLLARDS AT CAR PARK BOLTED  
TO FOUNDATION OR IN-GROUND  
SCALE 1:10 @ A1



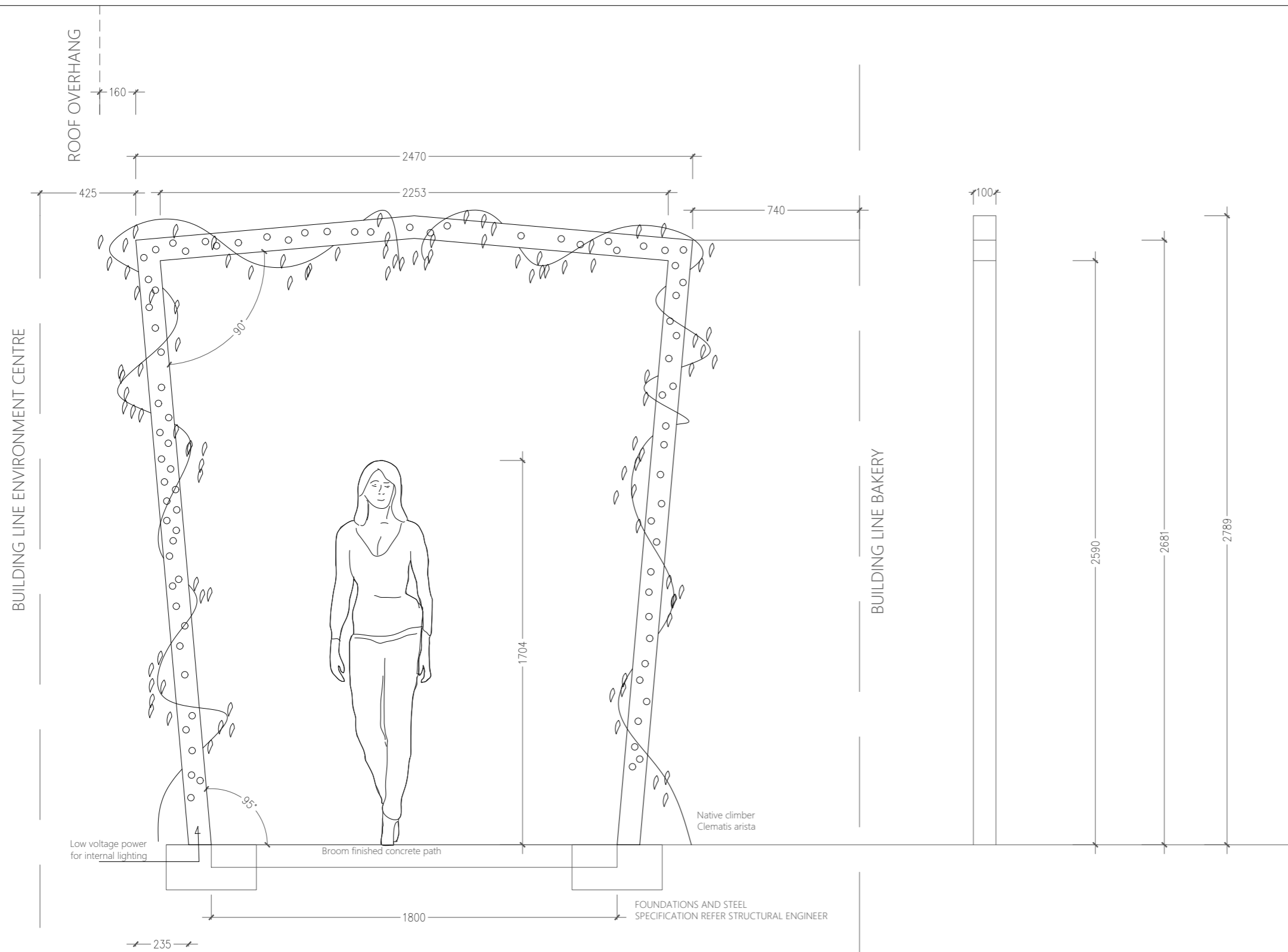

1  
0 SECTION FRONT ARCH SCALE 1:10 @ A1  
STEEL SQUARE TUBE- PERFORATED AND INTERNALLY LIT

1  
0 SECTION SIDE ARCH SCALE 1:10 @ A1



Character image- fabrication concept



Character image-illuminated pole



1  
0 CHARACTER IMAGES SEATING  
SCALE NTS

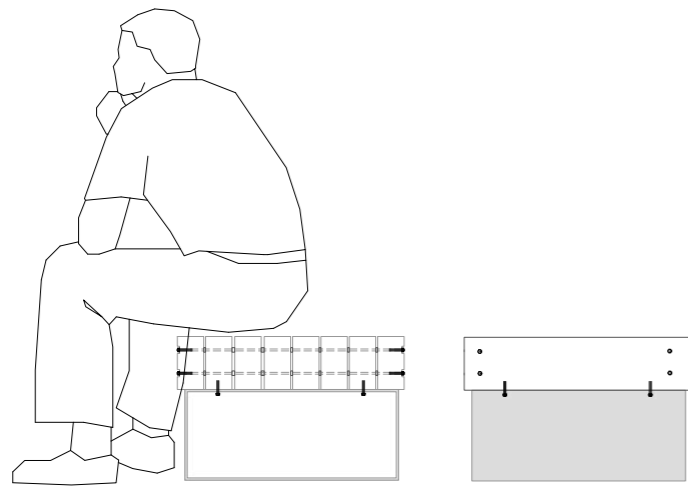

1  
0 TYPICAL DETAIL: SEATING type a  
SCALE 1:10 @ A1

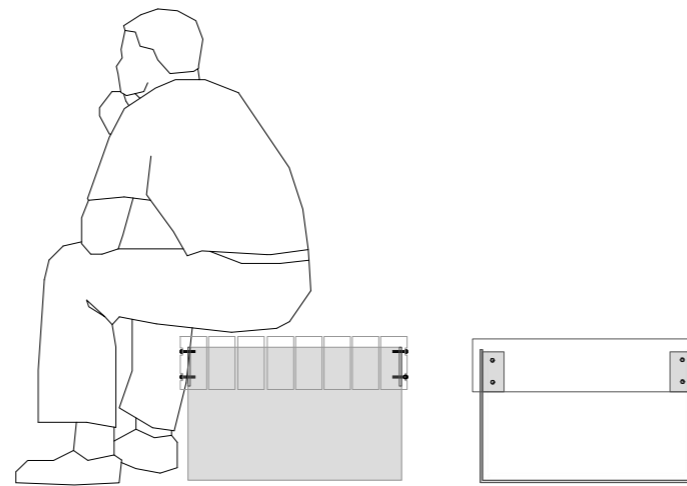

1  
0 TYPICAL DETAIL: SEATING type b  
SCALE 1:10 @ A1

# PLANTING PALETTE

Blueberry Ash is proposed as the infill tree and replacement tree as required over time at The Blister on Cullen Street.

Cudgerii is proposed as the entry feature tree at the start of the pedestrian link.

Blueberry Ash is proposed as the small shade tree at the blister

Groundcovers, low shrub, lilies and grasses are proposed for all other areas to provide colour and texture, resolve hard to manage or complicated edges and slopes while maintaining clear sight lines that provide no opportunity for concealment.



MYO par, Myoporum parvifolium Creeping, Boobialla



Lomandra Savannah Blue



Ophiopogon planiscapus Mono Grass



HEL gla, Helmholtzia glaberrima, Stream Lily.



FIC nod, Ficinia nodosa, Knobby Club-Rush.



Austroryrtus dulcis



CAR tes FC, Carex testacea Frosted Curls



CAR tes, Carex testacea, Orange Sedge.



ISO flu Isotoma fluviatilis, Swamp isotome



WES fru, Smoky, Westringea fruticosa. Varigated Coastal Rosemary



ROS off, Rosmarinus officinalis, Rosemary



RHO ant Rhodanthe anthomoides



Hoya australis Common Wax Flower



DIC rep Dicondria repens, Kidney Weed.



Dianella caerulea Blue Flax Lily



ZOY ten, Zoysia tenuifolia, Korean Temple Grass



MAT cha Matricaria chamomilla, Chamomile



ELA ret, Elaeocarpus reticulatus Blueberry Ash



FLI sch Flindersia Schottiana Cudgerii

# ENDNOTES - AUTHORS DETAILS AND DISCLAIMER

This document is to be read in the context of Landscape, Civil and Structural Engineering plans.  
Images from this document have not been attributed and may not be reproduced.

AUTHOR  
MARK PERKINS REGISTERED LANDSCAPE ARCHITECT  
AILA MEMBER NO 002060  
Version REVB  
-ISSUE Date. 2nd April 2023

ENNISMORE FIELD PTY LTD. Landscape Architects. ABN 93946429434, ACN 138864150, 16 Rainforest Drive, Eltham, NSW 2480.  
Web: <http://www.ennismorefield.com.au> Email: [office@ennismorefield.com.au](mailto:office@ennismorefield.com.au) Ph +61 447713999

## DISCLAIMER

*This document has been prepared for Lismore City Council as a preliminary version for review only. No reproduction in part or whole is permitted outside the necessary needs of the client without the written permission of Ennismore Field Pty Ltd. All findings and advice are current at the date of issue only and based solely on documents reports and drawings referenced in this document. The document is not guaranteed to be free from error or omission and no liability for any act done or omission made on the basis of information in this report is accepted by Ennismore Field Pty Ltd. We have not independently verified information provided by other consultants or referenced in this document and have made our findings and developed our designs based on the assumption that their findings are accurate at the date of issue. The concepts and information contained in this document are the copyright of Ennismore Field Pty Ltd. Use or duplication of this document in part or full without the written permission of Ennismore Field Pty Ltd constitutes infringement of copyright. The Moral Rights of the author apply.*

Cover Image-Cullen Street Nimbin-Proposed Wayfinding